

SPECIFICATIONS

- Substrate Material: BeO
- Resistive Film: Thick Film
- Tabs material /Finish: Ag
- Flange Material: Nickel Plated Copper (Cu/Ni)
- Cover substrate: Alumina
- Frequency: DC – 1GHz
- Capacitance: 4.2 pF
- Input Power: 400W
- Standards: MIL-DTL-39030
- Lead-Free, RoHS compliant

MECHANICAL OUTLINE

POWER DERATING

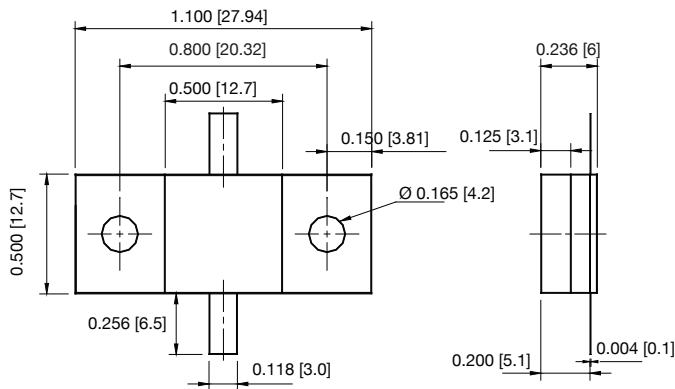

Dimension: inch [mm]

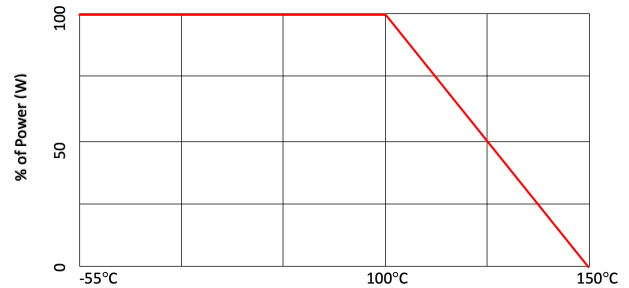

ORDERING INFO

Model	Material	Power (W)	Standard Resistance* (Ω)	Tolerance
EPFR	B = BeO	400	25 50 100 150	$\pm 5\%$

*Other values available upon request

Example: EPFR-1100-B400-100 (100 Ω , 5%)