

FLP-XDC-7000-SMF

Low Pass Filter, DC to 7000 MHz, 15 W

REV 1.00



The FLP-XDC-7000-SMF is a low pass filter that delivers exceptional performance in a small package size.

Features and Applications

- Low Insertion Loss
- High Stop Band Suppression
- Compact size
- High power

ELECTRICAL SPECIFICATIONS

| PARAMETER | SPECIFICATION |
|-----------------------|--|
| CUTOFF FREQUENCY | 7000 MHz |
| PASSBAND FREQUENCY | DC – 7000 MHz |
| INSERTION LOSS | ≤ 1 dB @ DC-6900 MHz ≤ 1.5 dB @ 6900-7000 MHz |
| PASSBAND VSWR | ≤ 1.3:1 |
| STOP BAND ATTENUATION | ≥50 dB @ 7700-15500 MHz |
| IMPEDANCE | 50 Ω |
| RF POWER | 15 W |

MECHANICAL SPECIFICATIONS

| PARAMETER | SPECIFICATION |
|----------------|-------------------------------------|
| CONNECTORS | SMA - (F) input SMA - (F) output |
| OPERATING TEMP | -55 °C to +85 °C |
| FINISH | BLACK PAINT |

MECHANICAL OUTLINE

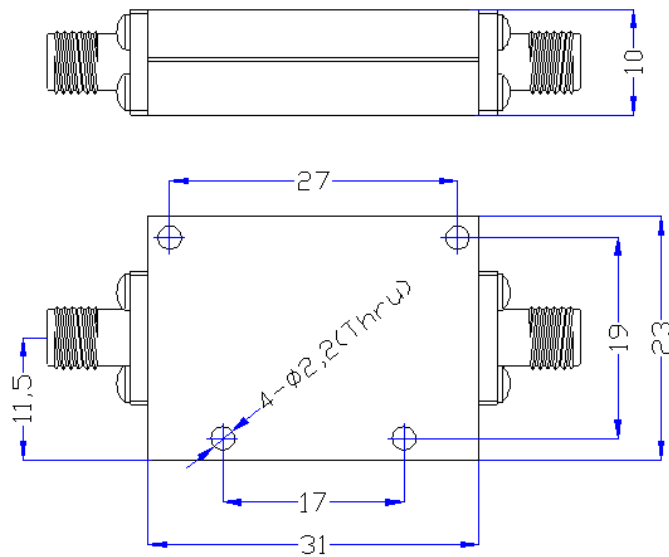

Units: mm

ORDERING INFO

| FLP - XDC - 7000 - SMF | | |
|------------------------|--------------|-------------------------------|
| PRODUCT CODE | CUTOFF FREQ. | CONNECTOR |
| FILTER | MHz | SMA - (MALE) SMA - (FEMLE) |

Electro-Photonics LLC reserves the right to modify drawings, configurations, specifications, and design at any time without prior notification.

FLP-XDC-7000-SMF

Low Pass Filter, DC to 7000 MHz, 15 W

REV 1.00

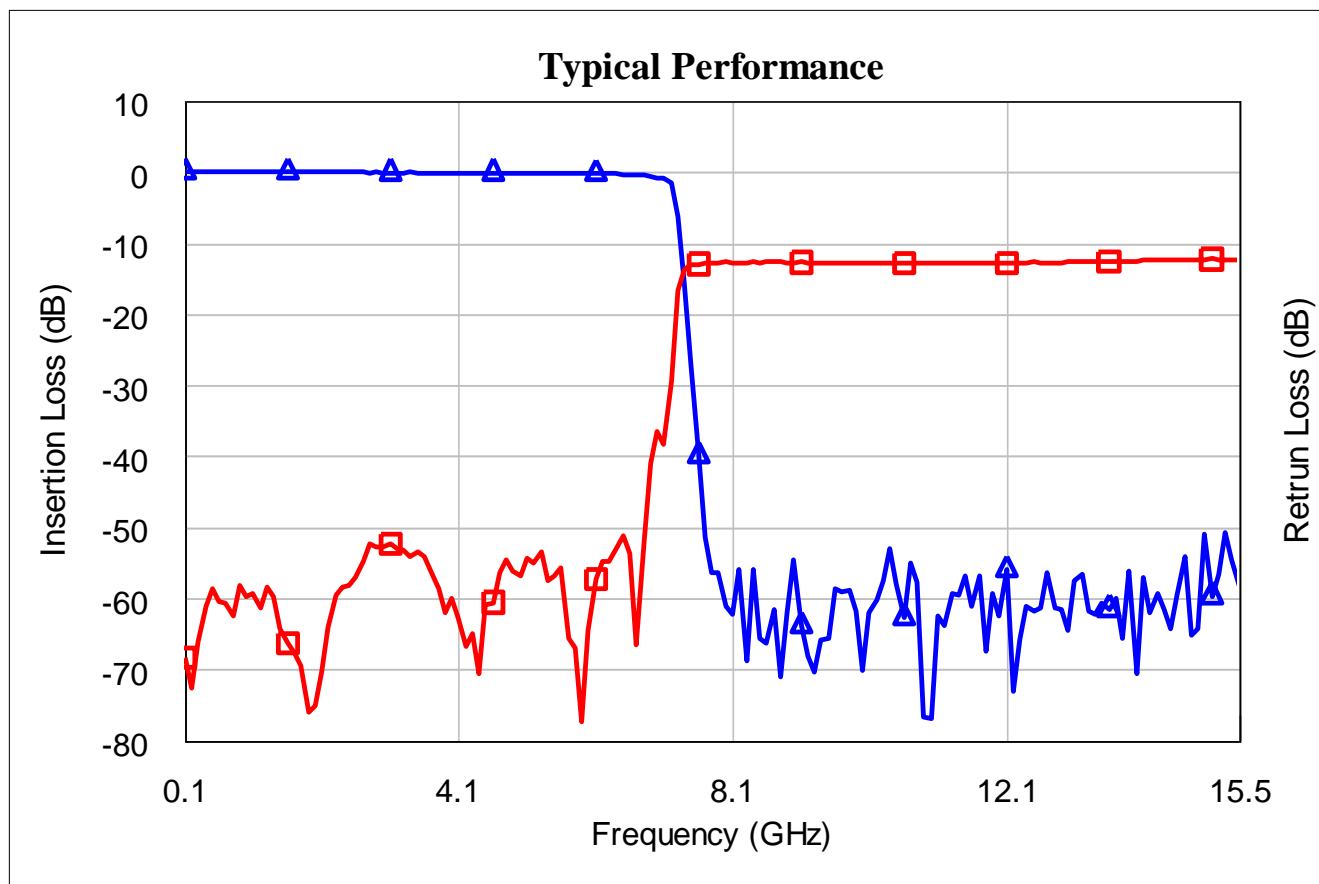

Electro-Photonics LLC reserves the right to modify drawings, configurations, specifications, and design at any time without prior notification.