

EP2D-1200R-M-001

SURFACE MOUNT 2-WAY POWER DIVIDER

REV 1.0.0



APPLICATIONS

- Signal splitting/combining
- Intermodulation distortion measurements
- Signal distribution for antenna arrays
- Antenna beam forming

FEATURES

- Broadband 6 - 18 GHz
- Surface Mountable
- Low insertion loss
- High isolation
- Low phase unbalance
- RoHS compliant

SPECIFICATIONS

TABLE 1: TYPICAL SPECIFICATIONS*

FREQ (GHz)	POWER† (W)	PART NUMBER	EXCESS LOSS (dB)	PHASE BALANCE (Deg)	ISOLATION Typical (dB)	INPUT RL (dB)	OUTPUT RL (dB)	AMPLITUDE BALANCE (dB)
6-18	1	EP2D-1200R-M-001	0.7	± 5	20	15	20	± 0.2

* Units tested with small signal using Electro-Photonics test board at 25°C. Load VSWR not to exceed 1.2:1. Base temperature not to exceed 85°C. Specifications subject to change without notice.

MECHANICAL OUTLINE

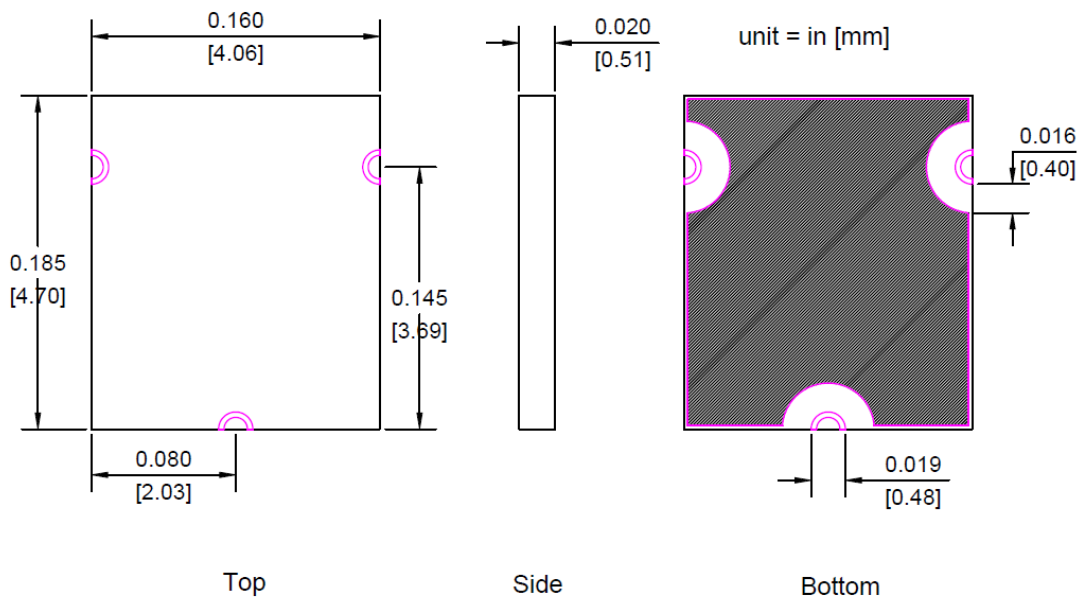

TYPICAL PERFORMANCE

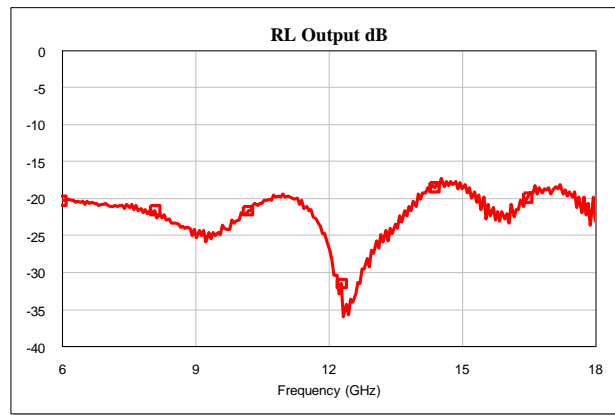
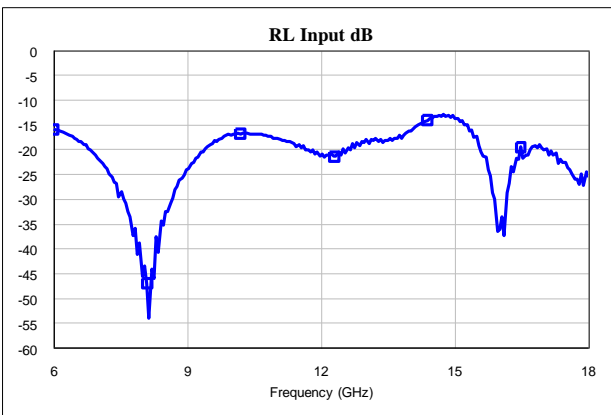
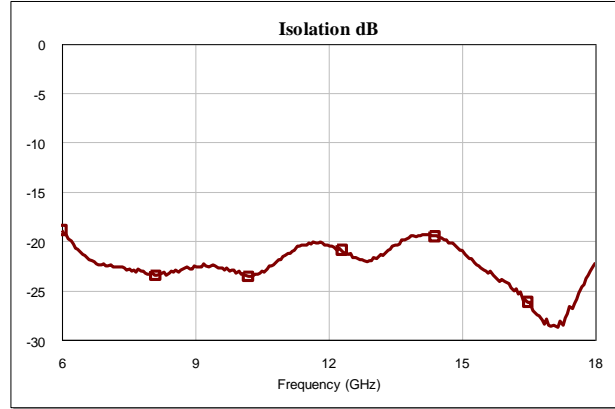
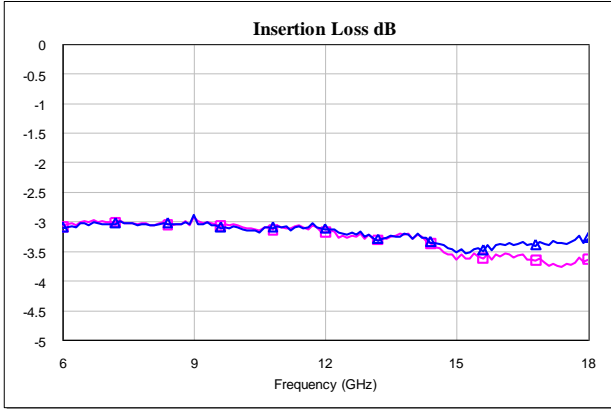

MOUNTING FOOTPRINT

Recommended PCB layout on 10 mil thick RO4350B material. Land pattern design must be taken into consideration when using a different thickness and/or dielectric constant in order to achieve optimal performance.

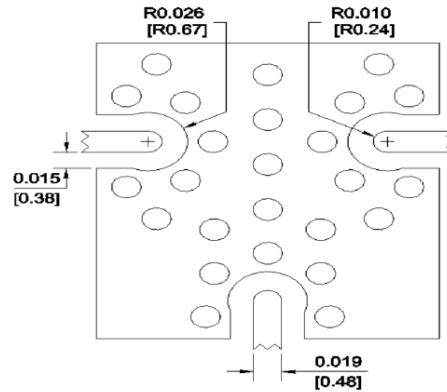

ORDERING INFO*

* Consult sales (sales@electro-photonics.com) for custom configuration, size, footprint, and/or specifications. Tape & Reel available upon request (with minimum order quantities).

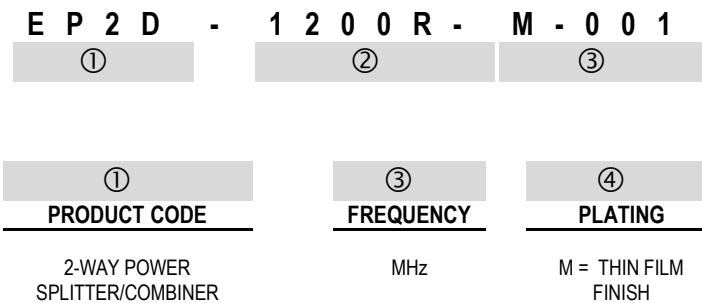

The EP2D-1200R-M-001 is a lead free, RoHS compliant product.

